

Press Release: April 2011

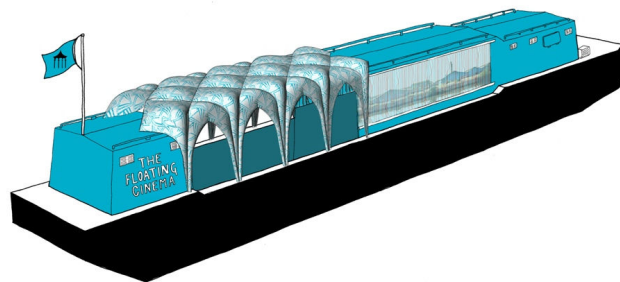

The Floating Cinema ‘home movie mash-up:’ a waterways themed film footage call-out.

The Floating Cinema is making a call-out for film and video footage based on or about the waterways.

The Floating Cinema’s vibrant and varied summer schedule is to include a very special home movie mix. The idea has been dreamt up by internationally renowned artists Nina Pope and Karen Guthrie (known collectively as *Somewhere*), who will be programming The Floating Cinema as it navigates the Olympic borough waterways from July to September.

Somewhere are asking for your film and video footage of canal holidays and experiences of the waterways – particularly East London’s waterways –over the years. The artists will splice together your cinematic submissions to create new film material which will be shown in The Floating Cinema’s intimate on board cinema, as well as being projected from the vessel onto surrounding waterways architecture for larger open-air screenings. A cinematic celebration of the unique character of the canal and waterways network, the mix screenings will offer audiences a brilliant insight into *Somewhere*’s resourceful and collaborative way of working with and within the diverse communities that make up life along the waterways.

So, are you keen to see your cinematic efforts screened by The Floating Cinema? Do you have some watery film footage suitable for *Somewhere* to ‘mix’? If so, we would love to see it.

Please send your film material as QuickTime files on CD/ DVD:

Somewhere, c/o Laura Harford,
19 Links Yard
29A Spelman Street
London
E1 5LX

The deadline for submissions is Wednesday 8th June.
If your footage is in another format please call to discuss.

For information please contact UP Projects on t: 020 7377 9677 e: laura@upprojects.com

www.portavilion.com

ENDS

Notes to Editors

The Floating Cinema is an Up Projects production developed by artists Nina Pope and Karen Guthrie (known collectively as Somewhere), and designed by Hackney based architects Studio Weave, to navigate the waterways of the five Olympic host boroughs during the summer 2011. It will accommodate intimate on-board film screenings, larger outdoor film events and provide a base for film-related activities led by Pope and Guthrie.

The Floating Cinema is part of Portavilion 2011, and will form an important strand of the cultural participation programme in the lead up to the 2012 Olympic and Paralympic Games. It will form part of the Create 11 summer festival, is commissioned by The Olympic Delivery Authority as part of their Arts and Cultural Strategy and funded by Arts Council England.

Somewhere is a multi-disciplinary, collaboration run by artists Nina Pope and Karen Guthrie. They produce ambitious, innovative and challenging projects spanning film, the web, installation, live events and public art. Recent work includes “What Will the Harvest Be?” a project at Abbey Gardens in Newham which transformed a former waste ground into a unique open access Harvest Garden. www.somewhere.org.uk

Studio Weave is a young energetic design practice working on art and architecture commissions across the country. They are currently working on a diverse set of projects from creating the world's longest bench along the south coast, to enhancing a number of high profile and heritage public spaces in the City of London, and they recently completed two allegorical pavilions at Kielder Water and Forest in Northumberland. www.studioweave.com

Portavilion is one of the most ambitious contemporary art projects to take place in London's public realm. Curated by **Emma Underhill of Up projects**, it launched in 2008 with four temporary pavilions by internationally renowned artists in some of London's most popular parks. In 2010, raumlaborberlin developed a mobile, inflatable pavilion that toured thirteen London parks and public spaces presenting a diverse programme of cultural events and activities produced in partnership with leading cultural organisations. This ongoing project explores the possibilities for temporary, large scale public art, and is as much a celebration of the city's most treasured open spaces as it is a cultural event. For 2011, the Floating Cinema with Somewhere and Studioweave takes the project into a new, water based territory, connecting the new Olympic Park to its host boroughs. www.portavilion.com

Up projects believes in challenging perceptions of what public art can be. Operating as if a gallery without walls, they are inspired by the complexities of the public realm to create a programme of artists' commissions, projects, strategies and multi-disciplinary events for a broad public audience. Since their first project in 2002, their work has consistently attracted considerable public attention. www.upprojects.com

The Olympic Delivery Authority has commissioned The Floating Cinema for Portavilion 2011 as part of their Inside Out series of art-led community engagement projects. As part of their strategy to integrate art into the Olympic Park, the Arts and Cultural Strategy team at the ODA has devised 'Inside Out' to complement the permanent commissions in the Park and focus on artists working with communities in the host boroughs. The first Inside Out commission *Memory Marathon* was conceived and produced by Film and Video Umbrella with artist Simon Pope, commissioned by the ODA and funded by the London Development Agency and Arts Council England. www.london2012.com

CREATE is the annual summer festival that celebrates Europe's largest cultural quarter: the Olympic Host Boroughs where over 12,000 artists live and work. Now in its fourth year, CREATE takes place between 24 June and 25 July in East and South East London. The festival will stage major commissions including the Bank of America Merrill Lynch CREATE Art Award worth £40,000, which this year has been awarded to Assemble 'Folly for a Flyover'; the CREATE11 Music series including Re:Definition, and Blaze, presented with the Barbican; CREATE11 Talks & Walks including The Midnight Run, a nocturnal walk across east London, and Alina Ibragimova / The Quay Brothers a co-commission with the Manchester International Festival and the Barbican. In addition CREATE11 will include over 200 art, design, film, music, and theatre events in galleries, outdoor spaces, music venues and pop-up spaces including The Floating Cinema, Gillett Square, Hackney Empire, Rich Mix, Theatre Royal Stratford East, the Vortex, Wilton's Music Hall and the Whitechapel Gallery. Global investment bank Deutsche Bank continue as main sponsor for the 2nd year. www.createlondon.org